



Sanitary, Low-Flow Cleaning

Toftejorg SaniMagnum Rotary Spray Head

Application

The Toftejorg SaniMagnum is an efficient replacement for traditional static spray balls as it uses low volumes of liquid at low pressure. The device, particularly well-suited to sanitary applications, can be used in tanks ranging from 5 m³ to 50 m³ (1,300 to 13,000 US gallons).

Sizing/selection and installation drawing are available in Alfa Laval CAS tool for Tank cleaning equipment.

Working principle

The flow of the cleaning media causes the head of the Toftejorg SaniMagnum to rotate, with fan jets laying out a swirling pattern throughout the vessel. This generates a vibrating impact and cascading flow that covers all internal surfaces of the tank or reactor. The device's self-cleaning feature is achieved by directing the cleaning media through the rotating bearing track and onto the neck of the elongated head.

Spray Pattern

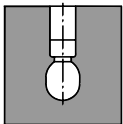

360° and 360° LF

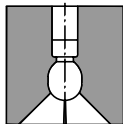

270° and 270° up LF**

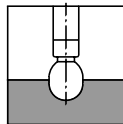

180° down

Standard Design

As standard documentation, the Toftejorg SaniMagnum can be supplied with a "Declaration of Conformity" for material specifications or 3.1.B certification for metallic parts. Conformity of Declaration ATEX directive 94/9/EC available on request. The device is available in hastelloy C22 (balls in hastelloy C276) with 3.1.B certification for metallic parts.

ATEX approved, Category 1 for installation in zone 0/20



Materials

Inlet connections:1.4404 (316L)
 Bearing race parts:SAF 2205 (UNS31803)
 Balls:1.4404 (316L)/PTFE*
 Head:1.4404 (316L)

(*FDA approved 21 CFR § 177.1550)



Ordering

Please specify desired spray pattern, required connections, material selection and type of certification required. Please also confirm the application suitable. ** Available on request.

Technical Data

Weight:Thread and clip-on: 0.76 kg (1.48 lbs)
On pipe: 0.97/1.52 kg (2.14/3.35 lbs)
 Lubricant:Self-lubricating with the cleaning fluid
 Working pressure:1 - 3 bar (14.5 - 44 psi)
 Recommended pressure:2 bar (29 psi)
 Max. working temperature:95 °C (203 °F)
 Max. ambient temperature:140 °C (284 °F)
 Wetting radius:Max. 3 m (10 ft)
 Impact cleaning radius:Max. effective 2 m (6 ft)
 Connection:1 1/4" Rp (BSP) or NPT thread. Clip-on or weld-on for pipe: ISO 2037, ASTM A270, BS4825 part 1, DIN11850 R1, DIN11850 R2, ASME BPE US & Schedule 40 pipe

Certificate:

2.2 - 3.1.B - ATEX

Options

- Downpipes with Tri-Clamp and flange connections

Flow Rate

m³/h, USgpm

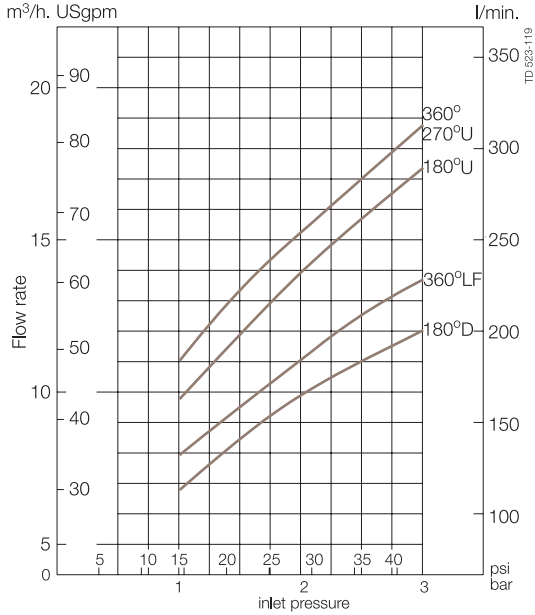

Cleaning radius

m, ft.

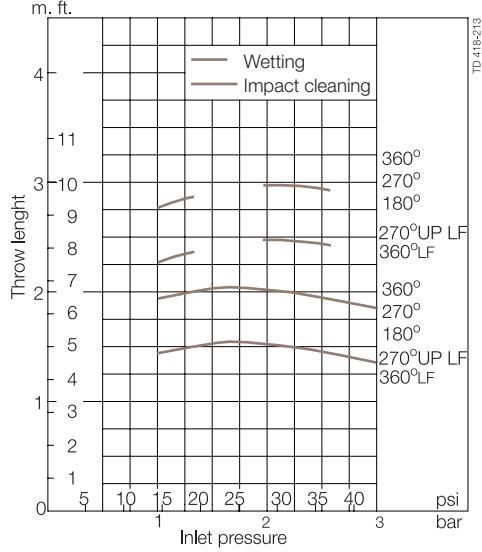

Dimensions (mm)

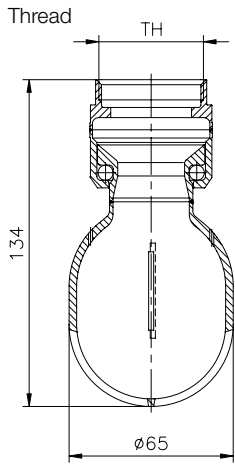

TH

- 1 1/4" BSP
- 1 1/4" NPT
- 1 1/2" BSP
- 1 1/2" NPT

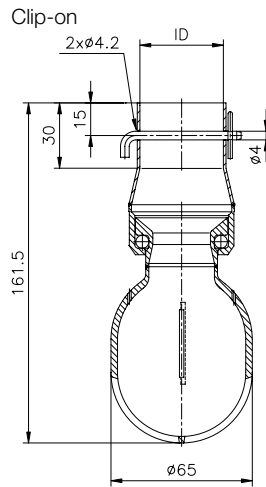

ID

- BPE / ISO 1 1/2" : $\phi 38.4$
- BPE / ISO 2" : $\phi 51.3$
- DIN, Range 1 : $\phi 40.4$
- DIN, Range 2 : $\phi 41.4$

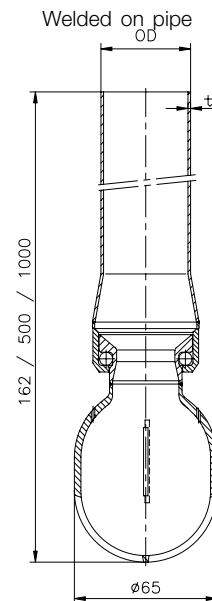

OD x t

- ISO : $\phi 38 \times 1.2$
- BPE US / ISO : $\phi 38,1 \times 1.65$
- BPE US / ISO : $\phi 50,8 \times 1.65$
- DIN, Range 1 : $\phi 40 \times 1$
- DIN, Range 2 : $\phi 41 \times 1.5$

ESE00332ENUS 0705

The information contained herein is correct at the time of issue,
but may be subject to change without prior notice.

How to contact Alfa Laval

Contact details for all countries
are continually updated on our website.
Please visit www.alfalaval.com to
access the information direct.